



TP series

Bill Acceptors
User Guide



Thank you for choosing TOP VME .



Contents



1. Introduction.....	1
1-1. Overview	1
1-2. Features	1
2. Specifications.....	2
2-1. General.....	2
2-2. Electrical	2
2-3. Mechanica	2
3. Packing List.....	2
4. Dimension	3
5. Installation	10
5-1. Harness Application.....	10
5-2. I/O Circuit.....	15
5-3. DIP Switch Setting	17
6. Maintenance	18
7. Troubleshooting	18



1. Introduction

1-1. Overview

TP series is a new generation of bill acceptor designed by TOPVME which features High-security with acceptance rate up to 96%. In addition, multiple bezel and bill box selections offer users the most convenient and complete services.

1-2. Features

- Four ways bill insertion acceptance
- High acceptance rate
- Multiple bezel selections
- Stacker with capacity of 500 bill are available, stacker with capacity of 800 bill are available. (TP70 special use)
- High security by protective mechanism

2. Specifications

2-1. General

Acceptance Rate	96% or gr eater
Interface	Pulse/RS232 、 Pulse/ccTalk 、 Pulse/TOP101
Installation	Indoor
Bill Inser tion	Four way acceptable

2-2. Electrical

Power Source	12V DC \pm 5%
Power Consumption	12V DC Standby : 350mA / 4.2W Motor Lock : 2A / 24W
Operation Environment	Operation Temperature : 0° C ~60° C
	Storage Temperature : -10° C ~80° C
	Humidity : 20%~70%RH (no condensation)

2-3. Mechanica

Weight	TP1/2-P5 Approx. 1.55Kg TP1-P8 Approx. 1.56Kg TP1/2/3/4 Approx. 0.70kg
Outline Dimension	Please refer to Chapter 4 - Dimension
Bill Box Capacity	Approx. 500 bills (P5 Series) Approx. 800 bills (P8 Series)
Bill Accepted Width	TP1 / TP1-K : 62 ~70mm TP2 : 66 ~77mm TP3 : 68~83mm

3. Packing List

Main	TP Bill Accept ors
Accessories	User Guide
	Dip Switch Setting Guide
	Harness : please refer to 5-1
	Bezel Sticker
	Metal Frame (Purchase)
	Screw Set (Purchase)
	Vandal-proof plate (Purchase)



4. Dimension

Unit : mm [inch]

TP1/TP1-P5 Upper Bezel

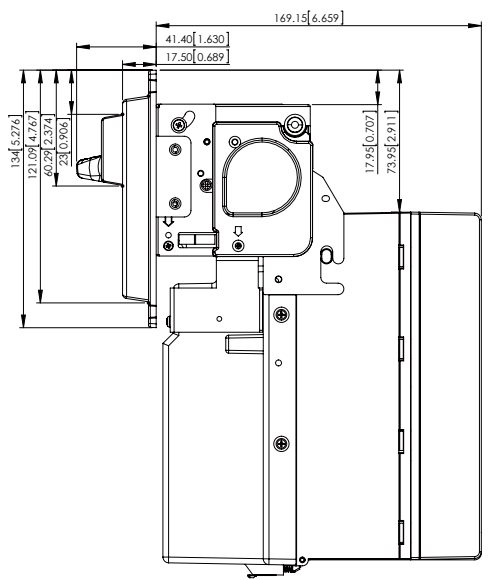
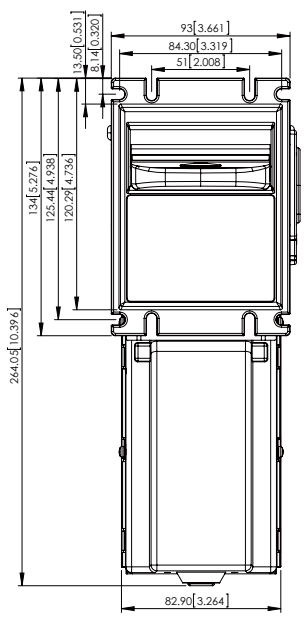
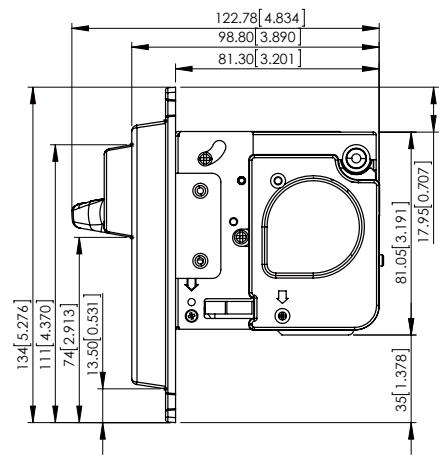
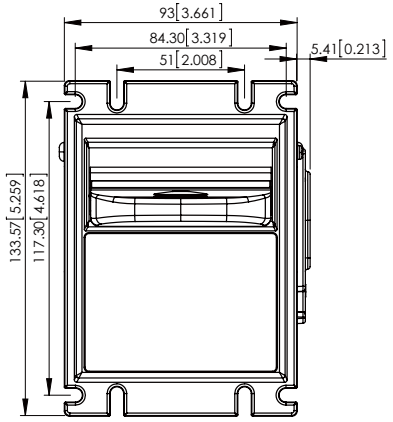



Unit : mm [inch]

TP1-P8 Upper Bezel

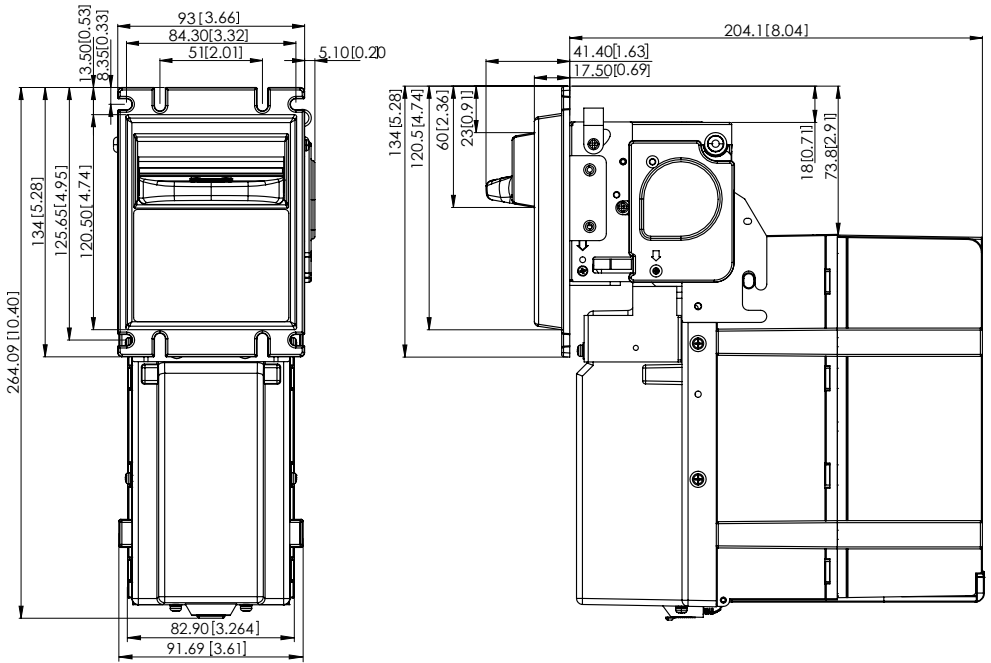



Unit : mm [inch]

TP1/TP1-P5-Middle Bezel

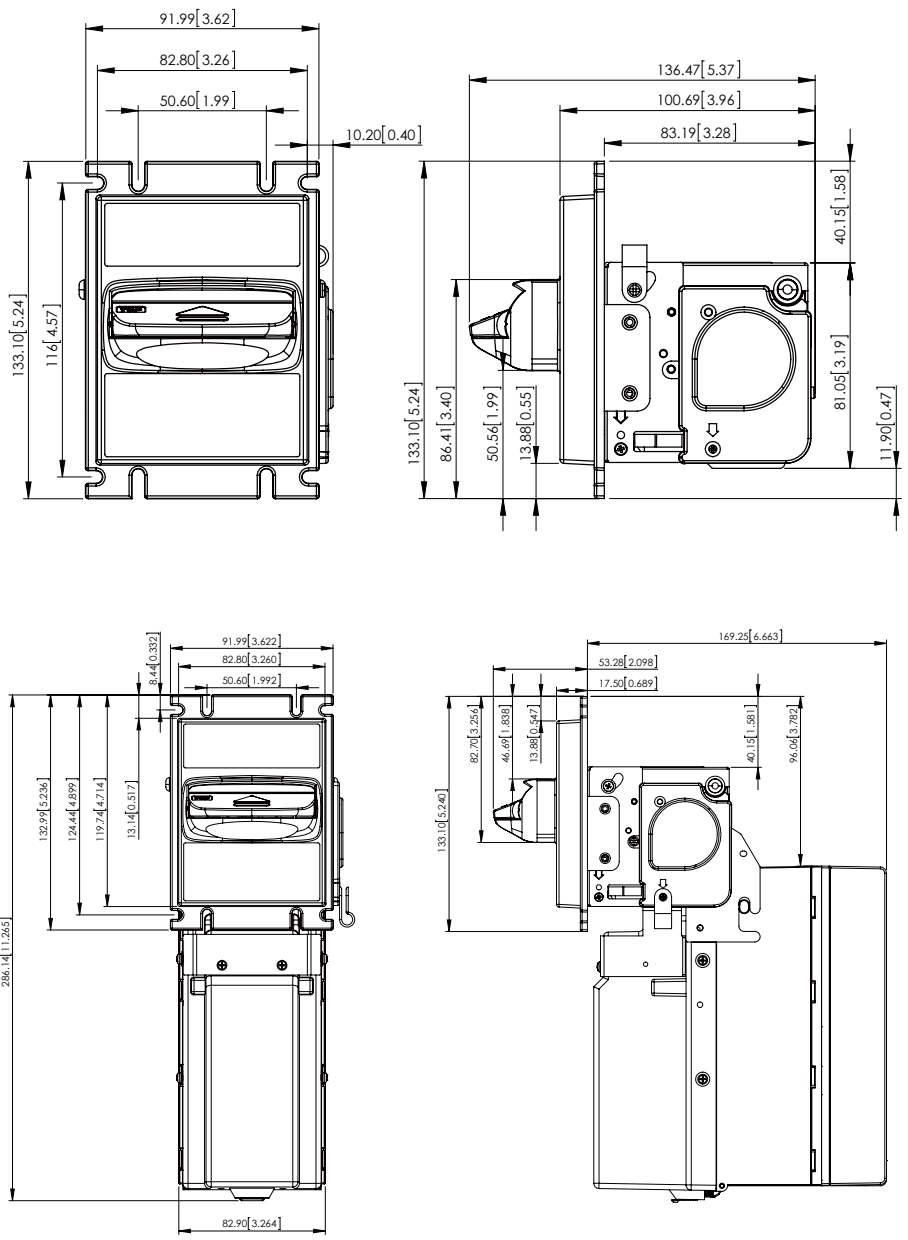



Unit : mm [inch]

TP1-P8-Middle Bezel

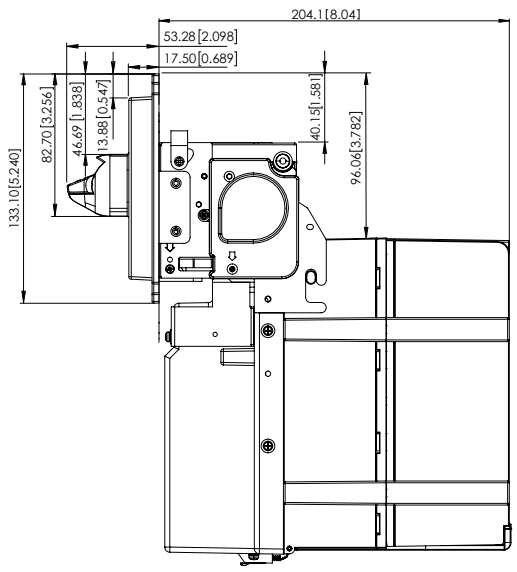
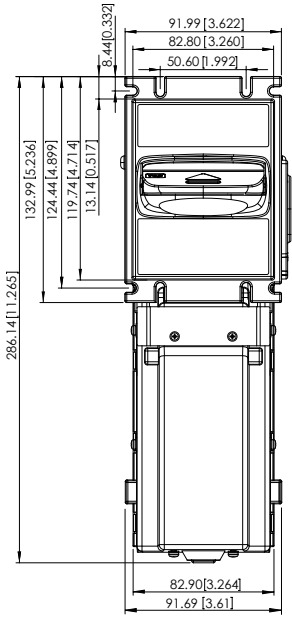



Unit : mm [inch]

TP2/TP2-P5 Upper Bezel

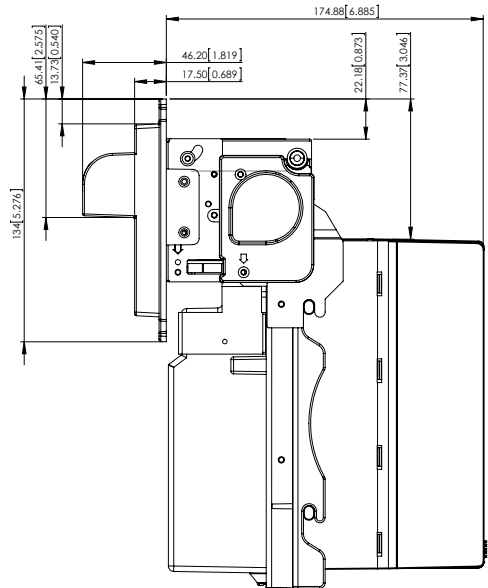
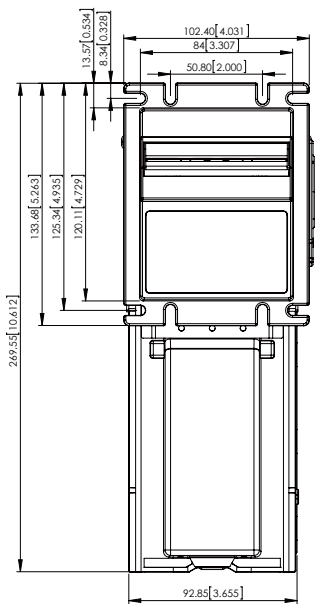
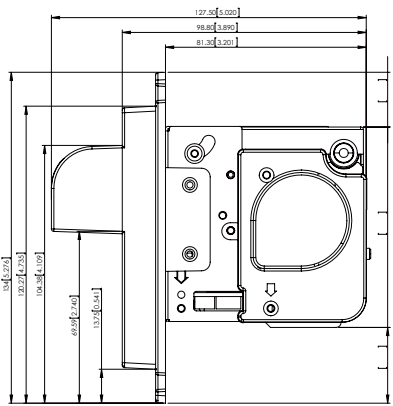
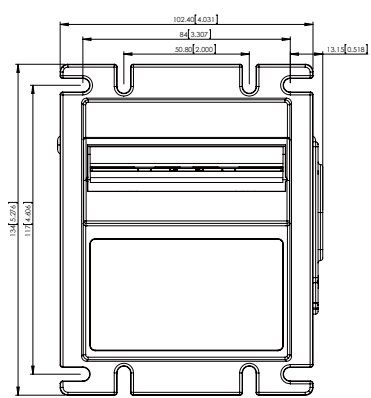



Unit : mm [inch]

TP2/TP2-P5 Middle Bezel

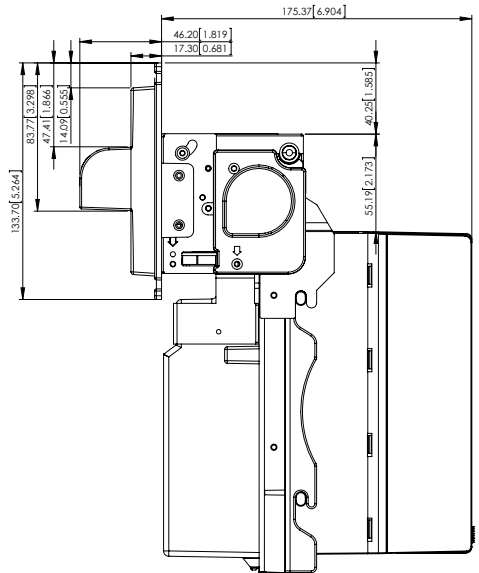
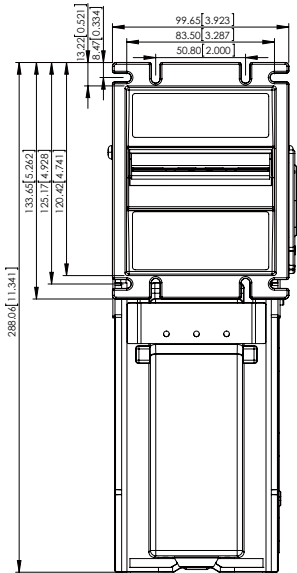
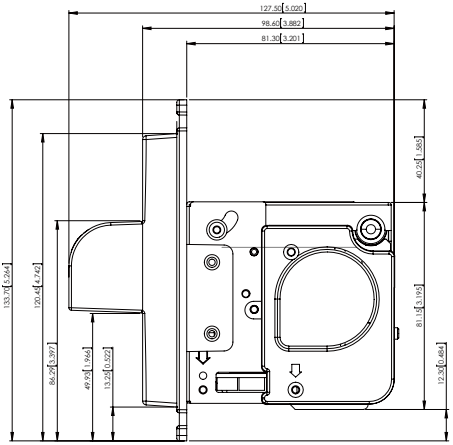
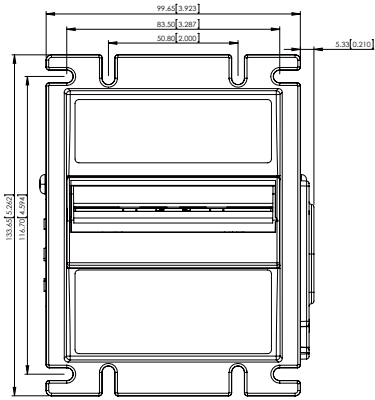



TP Series

Unit : mm [inch]

TP3 Middle Bezel

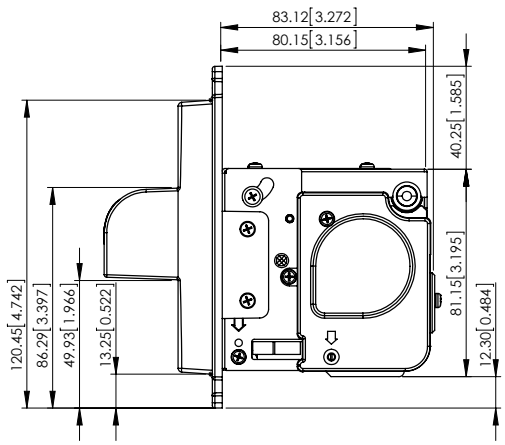
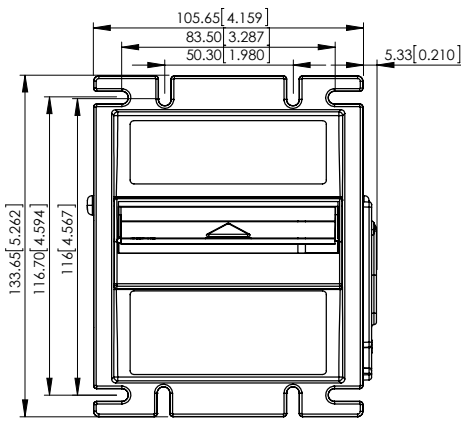

TP1-K Upper Bezel

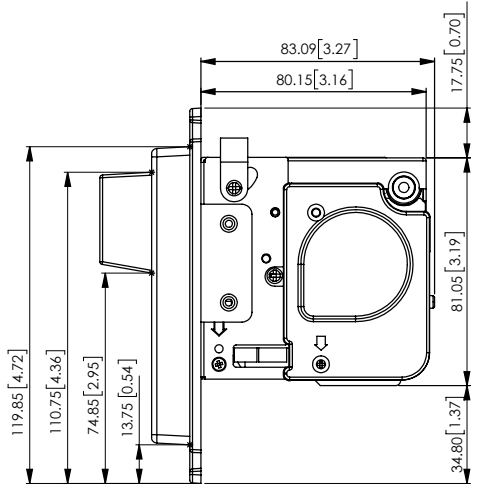
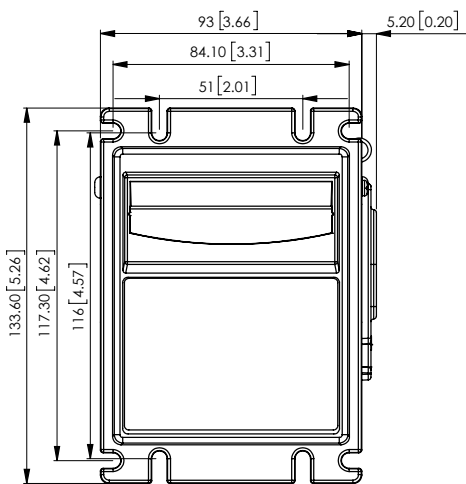



5. Installation

5-1. Harness Application

Interface	Voltage	Usage	Harness	Page
PULSE	12V DC	Power & Data Communication	WEL-R7U02	11
		Extension Cable	CU-R961-1	12
RS232		Power & Data Communication	WEL-R7U02	11
		Extension Cable	CU-R961-1	12
		Data Communication	WEL-R7U06	13
USB			Data Communication	2WIR-CP2102--00 (Purchase)

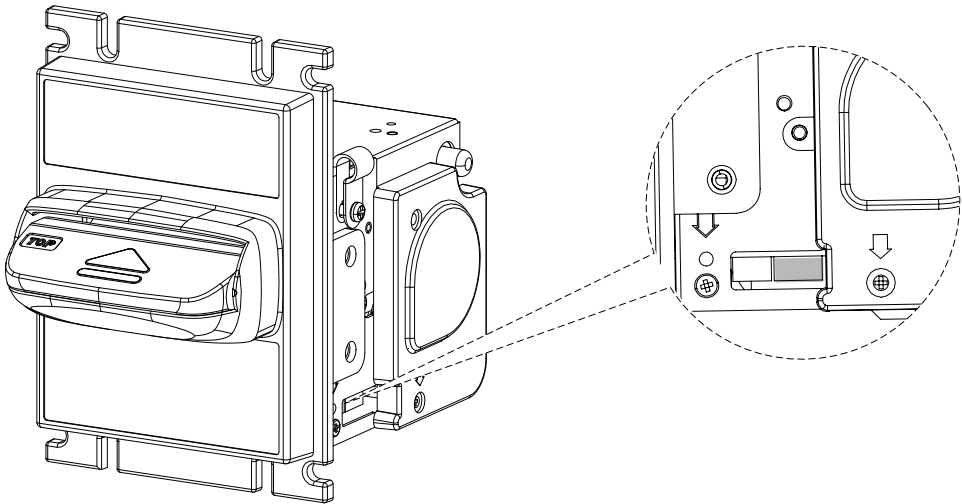

NOTE : Software download

Please refer to the G-BOX instruction manual for the download manual. You can obtain it from your local agent or contact us at the

service@topvme.com.tw.

HARNESS FORMAT

WEL-R7U02

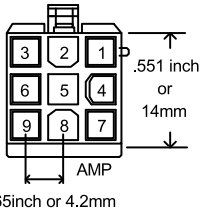
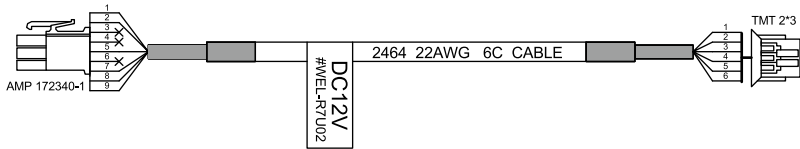

AMP 172340-1 BACK VIEW

PIN NO	COLOR	PIN DEFINE
PIN1	YELLOW	INHIBIT +
PIN2	GREEN	INHIBIT-
PIN5	RED	+12V DC
PIN7	BLUE	METER+
PIN8	PURPLE	METER-
PIN9	ORANGE	GND

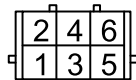

TMT 2*3 BACK VIEW

PIN NO	COLOR	PIN DEFINE
PIN1	RED	+12V DC
PIN2	ORANGE	GND
PIN3	YELLOW	INHIBIT +
PIN4	GREEN	INHIBIT-
PIN5	BLUE	METER+
PIN6	PURPLE	METER-

Topvme



HARNESS FORMAT

CU-R961-1

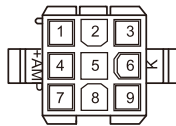
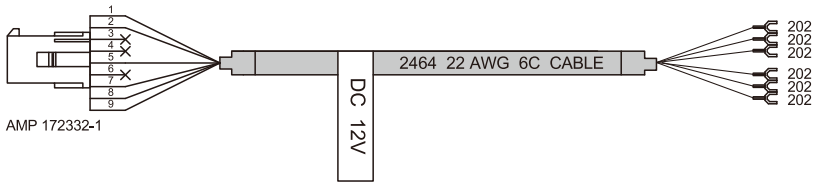

AMP 172332-1
BACK VIEW

PIN NO	COLOR	PIN DEFINE
PIN1	YELLOW	INHIBIT+
PIN2	GREEN	INHIBIT-
PIN5	RED	+12V DC
PIN7	BLUE	METER+
PIN8	PURPLE	METER-
PIN9	ORANGE	GND

Topvme



HARNESS FORMAT

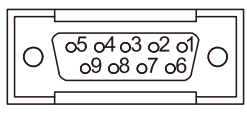
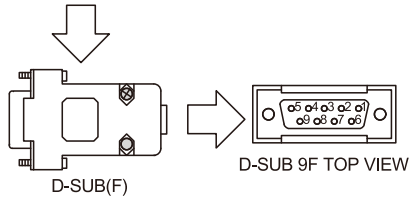
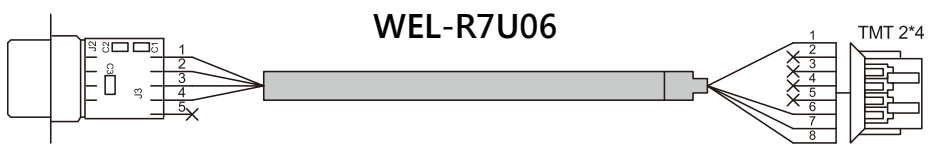

PIN NO	PIN DEFINE
PIN2	TXD
PIN3	RXD
PIN5	GND

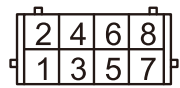

TMT 2*4 BACK VIEW

PIN NO	COLOR	PIN DEFINE
PIN1	BLUE	GND
PIN6	WHITE	VCC
PIN7	BLACK	RXD
PIN8	PURPLE	TXD

Topvme



HARNESS FORMAT

2WIR-CP2102N--00

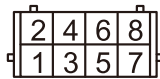
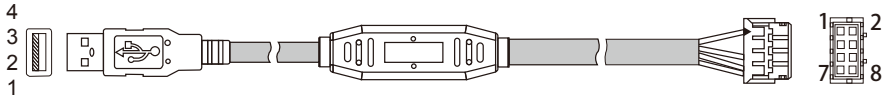

TMT 2*4 BACK VIEW

PIN NO	PIN DEFINE
PIN1	GND
PIN2	USB DP
PIN3	USB DM
PIN4	USB +5V

PIN NO	COLOR	PIN DEFINE
PIN1	BLUE	GND
PIN6	WHITE	NC
PIN7	BLACK	RXD
PIN8	PURPLE	TXD

Topvme



5-2. I/O Circuit

PULSE INTERFACE

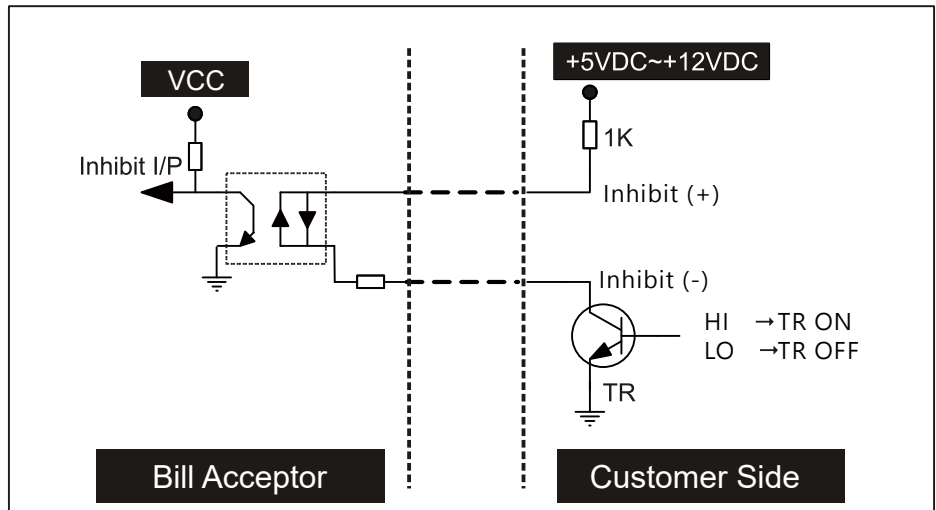
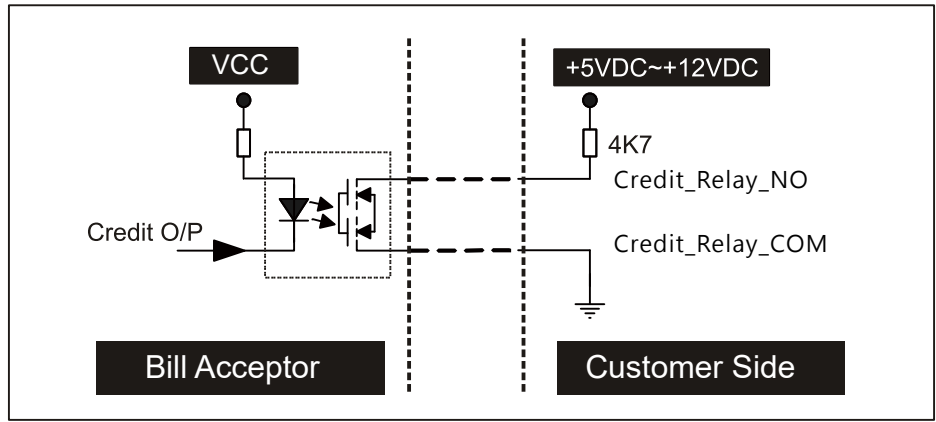

BA Status	DIP SW Setting	Control Signal
Inhibit	Inhibit Active	Low
		High
Enable	Inhibit Active	Low
		High



Standard RS232 Protocol

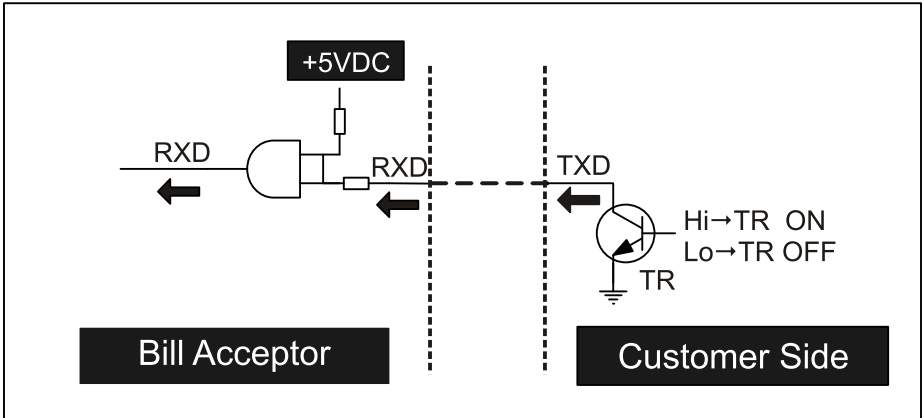
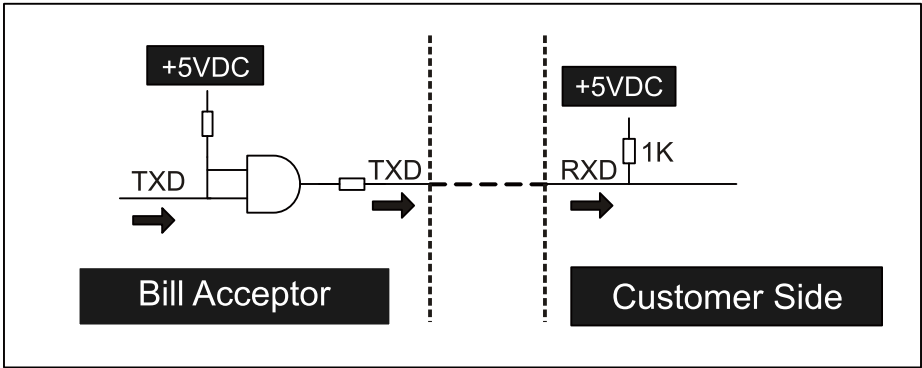



5-3. DIP Switch Setting

There are DIP switches located at the sides of the TP series. Varying on different currencies and credit output formats used; the DIP switch setting could vary to fit user's needs. The DIP switch located at the bottom of the TP series is intended for interface settings. Please refer to the "TP Series DIP Switch Setting Guide" in the package for more details.

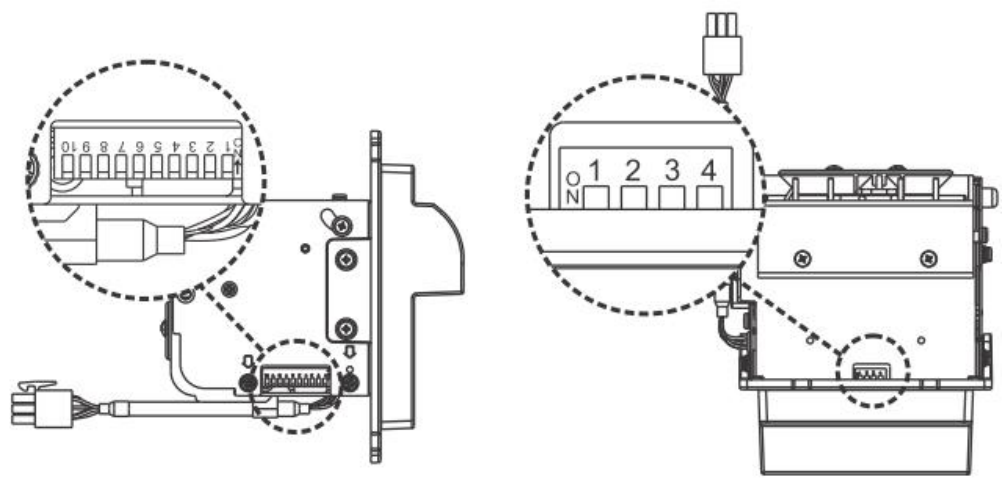



6. Maintenance

Foreign objects on the LED or sensor may cause bill jamming and decrease acceptance rate. To make sure the bill acceptor always works smoothly, please clean the internal parts regularly.

To clean the internal parts :

1. Turn Bill Acceptor off.
2. Open LED Assembly by pushing buttons on the back.
3. Use a soft, dry cloth or towel to clean the bill

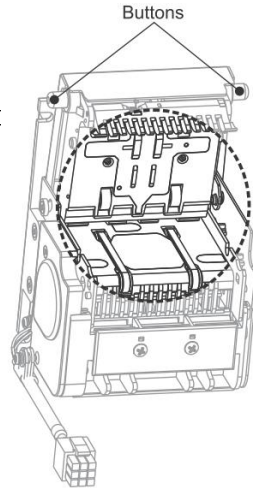

7. Troubleshooting

LED Flash	Status	Corrective Actions
1	Bill jammed	Open bill path unit and then remove the jammed bill.
2	Disable	Inspect for right DIP switch setting
3	Recognition sensor module error	Inspect for foreign objects on sensor or bill path and clean
3+2	Hook sensor error	Inspect for foreign objects on security hook and clean
3+4	Fish sensor error	Inspect for foreign objects on sensor or bill path and clean
4	A stringing attempt has detected	Inspect for foreign objects on sensor or bill path and clean
6	Stacker error or stacker full	Inspect for foreign objects on stacker and clean or wmpy the bill box
7	Motor error	Inspect for foreign objects on bill path and clean



Top Vending Machine Electronics Co., Ltd.

NO.11, Anzhong St., Luzhu Dist., Taoyuan City338, Taiwan, (R.O.C.)

Phone : +886-3-3115969 · Fax : +886-3-3115970

E-mail : sales@topvme.com.tw

Website : www.topvme.com



Top Vending Machine Electronics Co., Ltd.



www.topvme.com